

SafetyStar®

FLAMMABLES SAFETY CABINET

The widest used safety storage cabinets for industries and laboratories in the world.



ISO 9001



yakos™

TRIED & TRUSTED



► ***YAKOS65, A 40 Years Experience Manufacturer***

QUALITY

Quality is in our nature. All SafetyStar series Flammables Safety Cabinets are FM Approvals approved by the highest standards. For a product with FM Approvals approved, it represents quality excellence and guarantee over fire prevention, work safety and environmental protection. FM Approvals has been a trusted source of property loss prevention product evaluation for more than a century.

SATISFACTION

YAKOS65 manufactures the widest range of Flammables Safety Cabinets for a variety of stored media. The capacity for SafetyStar Flammables Safety Cabinets is from 4 gallon to 90 gallon. Three kinds of door, Single Door, Double Door and Sliding Door. Two door-closing types, Manual-closing and Self-closing. Six color options, Yellow, Red, Blue, Green, Grey and White. SafetyStar Flammables Safety Cabinets are ideal for use in Industry, Hospital, Electronics and Semiconductors, Laboratories, Stores, Warehouses and anywhere where hazardous materials need to be stored safely and securely.

ACTIVE

One of YAKOS65's top priorities is to provide our customers with a fast, flexible and cost-effective supply of our products wherever they are required. With more than 70 overseas partners and distributors, YAKOS65's product and service have successfully been expanding to over 30 countries. The ever-growing sales network offers seamless-service to our customers directly to anticipate and respond to local market needs.

- ▶ PROVIDES WORKERS AND ENVIRONMENT OPTIMUM SAFETY AND QUALITY ASSURANCE.
- ▶ PROVIDES MAXIMUM HUMAN LIFE AND PROPERTY PROTECTION.
- ▶ PREVENTS EXPLOSION, EXTENSION OF A FIRE.

YAKOS65™ is devoted to maintain the highest standards and professional certifications attainable in the industry. YAKOS65™ Flammables Safety Cabinets have been designed, manufactured and tested to comply with the following standards and certification.



Flammable Safety (Product Quality, Technical Integrity and Performance Testing and Certification):

FM Approvals Standard 6050: "Storage Cabinets for Ignitable (Flammable) Liquids". FM Approvals is an international leader in third-party testing and certification services for global industrial and commercial products. It is specified as the National Accreditation Laboratory (NRTL) in the United States Occupational Safety and Health Administration (OSHA). It is also recognized by the American National Standards Institute (ANSI) as a standard-setting body.



Fire Protection for Human Life and Property:

NFPA 30 section 6.3: "Design, Construction, and Capacity of Storage Cabinets". NFPA, The National Fire Protection Association, has long been the world's most recognized nonprofit organization dedicated to the protection of human life and property from the hazards of fire.



Safe and Healthful Working Conditions for Working Men and Women:

OSHA 29 CFR 1910.106(d)(3): "Design, Construction, and Capacity of Storage Cabinets". OSHA, The Occupational Safety and Health Administration, it's mission is to assure safe and healthful working conditions for working men and women by setting and enforcing standards and by providing training, outreach, education and assistance.



Quality Management System for Design and Manufacture of Flammables Safety Cabinets:

ISO 9001-2015: Quality management system requirements for facilities, people, training, services and equipments.



All SafetyStar® series Flammables Safety Cabinets are FM Approved and comply with NFPA and OSHA regulations.

FM Approval is a symbol of quality excellence, a guarantee over fire prevention, work safety and environmental protection.

YAKOS65™ SafetyStar® is the first Asian Flammables Safety Cabinet certified by FM Approvals. YAKOS65™ meets its clients' highest quality requirements by implementing the most stringent international testing standard to enhance workplace safety. YAKOS65™ believes that a safe working environment is the only way forward.



45 Gallon



45 Gallon



22 Gallon



4 Gallon



30 Gallon



11 Gallon

The First ASIAN Flammables Safety Cabinets Manufacturer Approved by FM.

YAKOS65TM provides a variety of colors of safety cabinet. Use colors and labels to segregate the stored items for easy identification and organization. It also helps the fireman quickly recognize hazards in the event of a fire.

The followings are the cabinet color direction for storing chemicals according to industry customary.

MORE COLORS, MORE SATISFACTION



Yellow for flammable liquids



Red for combustible liquids



Blue for corrosive liquids



Green for pesticides and insecticides



Grey for toxic substances



White for chemicals, complement and others



45 Gallon

45 Gallon

22 Gallon



12 Gallon

22 Gallon

Safety Comes from SafetyStar® Foresight Design and State of Art Technology

Safety comes from YAKOS65's insist on quality. All SafetyStar® safety cabinets are FM Approvals certified including the following safety design and features.

CABINET CONSTRUCTION

Double-wall cabinet construction with heavy-duty steel and 38mm air space efficiently isolates from combustion.

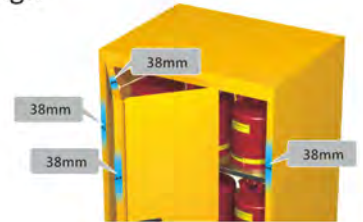

STEEL PIANO HINGE

1.2mm steel continuous piano hinge provides smooth closure, reliable and durable use.



DOOR CORNERS

Rounded corners avoid potential hand injury.



PADDLE HANDLE LATCH

Eliminates projecting obstacles. Easy open and close.



3-POINT LOCK

Non-sparking, 3-point linked latching device provides better security.



DUAL VENTS

Dual vents with flame arrester placed on both sides of the cabinets.



FLAME ARRESTER

To prevent exterior flame to enter the cabinet body and to prevent flame flees out from the safety cabinet.



GROUND WIRE

Able to guide static electricity to the ground, avoiding explosion caused by sparks.



LARGE WARNING LABEL

GALVANIZED STEEL SHELF



LEAK-TIGHT SUMP

2 inch deep leak-tight containment sump for accidental drips and spills.



LEVELERS

4 full steel adjustable levelers installed in base for stability.

For Fire Prevention, Work Safety, Environmental Protection. Reduces Your Industrial Safety Risks Once and for All.



▲ Easy to store items. Both manual and self-closing doors can be fully opened to 180°.



FM Approved logo Large "FLAMMABLES – KEEP FIRE AWAY" letter

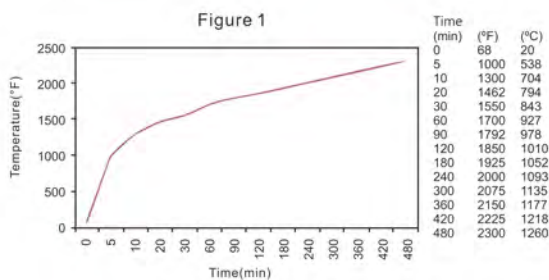

▲ Fire Exposure Test - ASTM E152 Time-Temperature Curve.

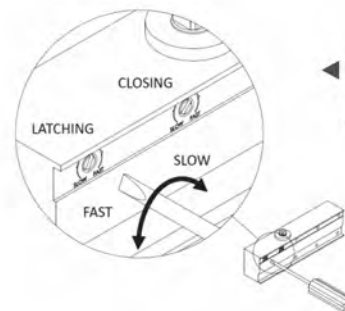

◀ Two way sections door closing, adjustable speed.

MANUAL-CLOSING DOOR

- Economical and practical type.
- Three cabinet styles: single-door cabinets, double-door cabinets and sliding-door cabinets.
- Non-sparking, 3-point linked latching device provides superior security.



▲ Actual fire exposure testing photo for safety cabinet conducted by FM.

SELF-CLOSING DOOR

- Three cabinet styles: single-door cabinets, double-door cabinets and sliding-door cabinets.
- Built-in thermal-sensitive device releases and closes door automatically if the cabinet is exposed at 74°C.
- Non-sparking, 3-point linked latching device provides superior security. Two way sections door closing, adjustable speed.
- When door opening angle is smaller than 85 degree, the door will automatically close.(sliding-door cabinets excluded)
- When door opening angle is greater than 90 degree, the door will stay open at its position.(sliding-door cabinets excluded)



▲ Adjustable galvanized steel shelves with at least 120kg loading capacity. Front and rear quick safety latch with closely integrated shelves and support frame reduces risks of collision.

Safety Cabinets for Flammable Liquid

Suitable for flammable liquids such as Ether, Heptane, Acetone, Ethanol, Gasoline, Methanol, Toluene etc.



- FM Approvals certified, comply with NFPA & OSHA regulations.
- Heavy-duty steel construction.
- Lead-free epoxy powder coating finish.
- Double wall construction with 38mm air space efficiently isolates from combustion.
- Galvanized steel shelves.
- 3-point self-latching doors with all non-spark latching.
- Paddle handle locking latch.
- 1.2mm cold-rolled continuous piano hinge.
- Adjustable zinc plated leveling feet.
- Dual 2" vents with caps and flame arrester placed at both side of cabinets.
- Large warning label.
- Static grounding wire (UL listed).
- 2 inch deep leak-tight containment sump.



Vent-Filtration Box for safety cabinets. Easy installation on the top of cabinets to effectively remove the vapor inside the cabinets by filtration.

Capacity gallon	Ext. Dim. W*D*H mm	Int. Dim. W*D*H mm	No. of Shelves	Door Type	Order No.	Approval	Compliance
4	435*435*630	352*352*483	1	Single door/manual close	M1004Y-R	FM	NFPA, OSHA
				Single door/self close	S1004Y-R		
12	595*460*960	512*377*813	1	Single door/manual close	M1012Y-R	FM	NFPA, OSHA
				Single door/self close	S1012Y-R		
15	595*460*1190	512*377*1043	1	Single door/manual close	M1015Y-R	FM	NFPA, OSHA
				Single door/self close	S1015Y-R		
22	595*460*1720	512*377*1573	3	Single door/manual close	M1022Y-R	FM	NFPA, OSHA
				Single door/self close	S1022Y-R		
54	595*860*1720	512*777*1573	3	Single door/manual close	M1054Y-R	FM	NFPA, OSHA
				Single door/self close	S1054Y-R		
30	1090*460*1190	1007*377*1043	1	Double door/manual close	M2030Y	FM	NFPA, OSHA
				Double door/self close	S2030Y		
45	1090*460*1720	1007*377*1573	2	Double door/manual close	M2045Y	FM	NFPA, OSHA
				Double door/self close	S2045Y		
60	860*860*1720	777*777*1573	2	Double door/manual close	M2060Y	FM	NFPA, OSHA
				Double door/self close	S2060Y		
90	1090*860*1720	1007*777*1573	2	Double door/manual close	M2090Y	FM	NFPA, OSHA
				Double door/self close	S2090Y		

※Sliding door cabinets are available, if needed, please contact your local sales representative for detail.

※Extra steel shelves can be ordered.

Safety Cabinets for Combustible Liquid

Suitable for combustible liquids such as Diesel oil, Fuel oil, Kerosene, Oil, Mineral oil, Ethylene glycol, Glycerol etc.



- FM Approvals certified, comply with NFPA & OSHA regulations.
- Heavy-duty steel construction.
- Lead-free epoxy powder coating finish.
- Double wall construction with 38mm air space efficiently isolates from combustion.
- Galvanized steel shelves.
- 3-point self-latching doors with all non-spark latching.
- Paddle handle locking latch.
- 1.2mm cold-rolled continuous piano hinge.
- Adjustable zinc plated leveling feet.
- Dual 2" vents with caps and flame arrester placed at both side of cabinets.
- Large warning label.
- Static grounding wire (UL listed).
- 2 inch deep leak-tight containment sump.



Capacity gallon	Ext. Dim. W*D*H mm	Int. Dim. W*D*H mm	No. of Shelves	Door Type	Order No.	Approval	Compliance
4	435*435*630	352*352*483	1	Single door/manual close	M1004R-R	FM	NFPA, OSHA
				Single door/self close	S1004R-R		
12	595*460*960	512*377*813	1	Single door/manual close	M1012R-R	FM	NFPA, OSHA
				Single door/self close	S1012R-R		
15	595*460*1190	512*377*1043	1	Single door/manual close	M1015R-R	FM	NFPA, OSHA
				Single door/self close	S1015R-R		
22	595*460*1720	512*377*1573	3	Single door/manual close	M1022R-R	FM	NFPA, OSHA
				Single door/self close	S1022R-R		
54	595*860*1720	512*777*1573	3	Single door/manual close	M1054R-R	FM	NFPA, OSHA
				Single door/self close	S1054R-R		
30	1090*460*1190	1007*377*1043	1	Double door/manual close	M2030R	FM	NFPA, OSHA
				Double door/self close	S2030R		
45	1090*460*1720	1007*377*1573	2	Double door/manual close	M2045R	FM	NFPA, OSHA
				Double door/self close	S2045R		
60	860*860*1720	777*777*1573	2	Double door/manual close	M2060R	FM	NFPA, OSHA
				Double door/self close	S2060R		
90	1090*860*1720	1007*777*1573	2	Double door/manual close	M2090R	FM	NFPA, OSHA
				Double door/self close	S2090R		

※Sliding door cabinets are available, if needed, please contact your local sales representative for detail.
 ※Extra steel shelves can be ordered.

Safety Cabinets for Corrosives

Suitable for weak corrosive liquid such as Formic acid, Acetic acid, Phosphoric acid, Nitrous acid and Benzoic acid etc.

※ Steel cabinets are suitable for storing weak corrosive chemicals, not recommended for the storage of strong acids such as sulfuric, hydrochloric, nitric and perchloric.



- FM Approvals certified, comply with NFPA & OSHA regulations.
- Heavy-duty steel construction.
- Lead-free epoxy powder coating finish.
- Double wall construction with 38mm air space efficiently isolates from combustion.
- Galvanized steel shelves.
- 3-point self-latching doors with all non-spark latching.
- Paddle handle locking latch.
- 1.2mm cold-rolled continuous piano hinge.
- Adjustable zinc plated leveling feet.
- Dual 2" vents with caps and flame arrester placed at both side of cabinets.
- Large warning label.
- Static grounding wire (UL listed).
- 2 inch deep leak-tight containment sump.
- Include PP trays on shelf and the bottom of the cabinet to contain spills for extra corrosion protection.



Capacity gallon	Ext. Dim. W*D*H mm	Int. Dim. W*D*H mm	No. of Shelves	Door Type	Order No.	Approval	Compliance
4	435*435*630	352*352*483	1	Single door/manual close	M1004B-R	FM	NFPA, OSHA
				Single door/self close	S1004B-R		
12	595*460*960	512*377*813	1	Single door/manual close	M1012B-R	FM	NFPA, OSHA
				Single door/self close	S1012B-R		
15	595*460*1190	512*377*1043	1	Single door/manual close	M1015B-R	FM	NFPA, OSHA
				Single door/self close	S1015B-R		
22	595*460*1720	512*377*1573	3	Single door/manual close	M1022B-R	FM	NFPA, OSHA
				Single door/self close	S1022B-R		
54	595*860*1720	512*777*1573	3	Single door/manual close	M1054B-R	FM	NFPA, OSHA
				Single door/self close	S1054B-R		
30	1090*460*1190	1007*377*1043	1	Double door/manual close	M2030B	FM	NFPA, OSHA
				Double door/self close	S2030B		
45	1090*460*1720	1007*377*1573	2	Double door/manual close	M2045B	FM	NFPA, OSHA
				Double door/self close	S2045B		
60	860*860*1720	777*777*1573	2	Double door/manual close	M2060B	FM	NFPA, OSHA
				Double door/self close	S2060B		
90	1090*860*1720	1007*777*1573	2	Double door/manual close	M2090B	FM	NFPA, OSHA
				Double door/self close	S2090B		

※Sliding door cabinets are available, if needed, please contact your local sales representative for detail.

※Extra steel shelves and PP trays can be ordered.

Safety Cabinets for Pesticides

Suitable for pesticides such as herbicide, Insecticides, Fungicides, Rodenticides, Fungicides and Disinfectants etc.



- FM Approvals certified, comply with NFPA & OSHA regulations.
- Heavy-duty steel construction.
- Lead-free epoxy powder coating finish.
- Double wall construction with 38mm air space efficiently isolates from combustion.
- Galvanized steel shelves.
- 3-point self-latching doors with all non-spark latching.
- Paddle handle locking latch.
- 1.2mm cold-rolled continuous piano hinge.
- Adjustable zinc plated leveling feet.
- Dual 2" vents with caps and flame arrester placed at both side of cabinets.
- Large warning label.
- Static grounding wire (UL listed).
- 2 inch deep leak-tight containment sump.



Capacity gallon	Ext. Dim. W*D*H mm	Int. Dim. W*D*H mm	No. of Shelves	Door Type	Order No.	Approval	Compliance
4	435*435*630	352*352*483	1	Single door/manual close	M1004GN-R	FM	NFPA, OSHA
				Single door/self close	S1004GN-R		
12	595*460*960	512*377*813	1	Single door/manual close	M1012GN-R	FM	NFPA, OSHA
				Single door/self close	S1012GN-R		
15	595*460*1190	512*377*1043	1	Single door/manual close	M1015GN-R	FM	NFPA, OSHA
				Single door/self close	S1015GN-R		
22	595*460*1720	512*377*1573	3	Single door/manual close	M1022GN-R	FM	NFPA, OSHA
				Single door/self close	S1022GN-R		
54	595*860*1720	512*777*1573	3	Single door/manual close	M1054GN-R	FM	NFPA, OSHA
				Single door/self close	S1054GN-R		
30	1090*460*1190	1007*377*1043	1	Double door/manual close	M2030GN	FM	NFPA, OSHA
				Double door/self close	S2030GN		
45	1090*460*1720	1007*377*1573	2	Double door/manual close	M2045GN	FM	NFPA, OSHA
				Double door/self close	S2045GN		
60	860*860*1720	777*777*1573	2	Double door/manual close	M2060GN	FM	NFPA, OSHA
				Double door/self close	S2060GN		
90	1090*860*1720	1007*777*1573	2	Double door/manual close	M2090GN	FM	NFPA, OSHA
				Double door/self close	S2090GN		

※Sliding door cabinets are available, if needed, please contact your local sales representative for detail.
 ※Extra steel shelves can be ordered.

Safety Cabinets for Class 6 Toxic Substances

All toxic substances safety cabinets are designed to comply with Australian Standard AS4452. Suitable for pesticides such as Cyanides, Lead compounds, Phenol and Cresols etc.

※ Class 6 Toxic Substances (AS4452-1997)
Substances liable either to cause death or serious injury or to harm human health if swallowed or inhaled or by skin contact.



- FM Approvals certified, comply with NFPA & OSHA regulations.
- Heavy-duty steel construction.
- Lead-free epoxy powder coating finish.
- Double wall construction with 38mm air space efficiently isolates from combustion.
- Galvanized steel shelves.
- 3-point self-latching doors with all non-spark latching.
- Paddle handle locking latch.
- 1.2mm cold-rolled continuous piano hinge.
- Adjustable zinc plated leveling feet.
- Dual 2" vents with caps and flame arrester placed at both side of cabinets.
- Large warning label.
- Static grounding wire (UL listed).
- 2 inch deep leak-tight containment sump.



Vent-Filtration Box for safety cabinets. Easy installation on the top of cabinets to effectively remove the vapor inside the cabinets by filtration.

Capacity gallon	Ext. Dim. W*D*H mm	Int. Dim. W*D*H mm	No. of Shelves	Door Type	Order No.	Approval	Compliance
4	435*435*630	352*352*483	1	Single door/manual close	M1004GY-R	FM	NFPA, OSHA
				Single door/self close	S1004GY-R		
12	595*460*960	512*377*813	1	Single door/manual close	M1012GY-R	FM	NFPA, OSHA
				Single door/self close	S1012GY-R		
15	595*460*1190	512*377*1043	1	Single door/manual close	M1015GY-R	FM	NFPA, OSHA
				Single door/self close	S1015GY-R		
22	595*460*1720	512*377*1573	3	Single door/manual close	M1022GY-R	FM	NFPA, OSHA
				Single door/self close	S1022GY-R		
54	595*860*1720	512*777*1573	3	Single door/manual close	M1054GY-R	FM	NFPA, OSHA
				Single door/self close	S1054GY-R		
30	1090*460*1190	1007*377*1043	1	Double door/manual close	M2030GY	FM	NFPA, OSHA
				Double door/self close	S2030GY		
45	1090*460*1720	1007*377*1573	2	Double door/manual close	M2045GY	FM	NFPA, OSHA
				Double door/self close	S2045GY		
60	860*860*1720	777*777*1573	2	Double door/manual close	M2060GY	FM	NFPA, OSHA
				Double door/self close	S2060GY		
90	1090*860*1720	1007*777*1573	2	Double door/manual close	M2090GY	FM	NFPA, OSHA
				Double door/self close	S2090GY		

※Sliding door cabinets are available, if needed, please contact your local sales representative for detail.

※Extra steel shelves can be ordered.

Safety Cabinets for Chemicals

For general safe chemical storage purpose. Locked cabinet that serves as an ideal solution for locking up and classifying your chemicals.



- FM Approvals certified, comply with NFPA & OSHA regulations.
- Heavy-duty steel construction.
- Lead-free epoxy powder coating finish.
- Double wall construction with 38mm air space efficiently isolates from combustion.
- Galvanized steel shelves.
- 3-point self-latching doors with all non-spark latching.
- Paddle handle locking latch.
- 1.2mm cold-rolled continuous piano hinge.
- Adjustable zinc plated leveling feet.
- Dual 2" vents with caps and flame arrester placed at both side of cabinets.
- Large warning label.
- Static grounding wire (UL listed).
- 2 inch deep leak-tight containment sump.



Capacity gallon	Ext. Dim. W*D*H mm	Int. Dim. W*D*H mm	No. of Shelves	Door Type	Order No.	Approval	Compliance
4	435*435*630	352*352*483	1	Single door/manual close	M1004W-R	FM	NFPA, OSHA
				Single door/self close	S1004W-R		
12	595*460*960	512*377*813	1	Single door/manual close	M1012W-R	FM	NFPA, OSHA
				Single door/self close	S1012W-R		
15	595*460*1190	512*377*1043	1	Single door/manual close	M1015W-R	FM	NFPA, OSHA
				Single door/self close	S1015W-R		
22	595*460*1720	512*377*1573	3	Single door/manual close	M1022W-R	FM	NFPA, OSHA
				Single door/self close	S1022W-R		
54	595*860*1720	512*777*1573	3	Single door/manual close	M1054W-R	FM	NFPA, OSHA
				Single door/self close	S1054W-R		
30	1090*460*1190	1007*377*1043	1	Double door/manual close	M2030W	FM	NFPA, OSHA
				Double door/self close	S2030W		
45	1090*460*1720	1007*377*1573	2	Double door/manual close	M2045W	FM	NFPA, OSHA
				Double door/self close	S2045W		
60	860*860*1720	777*777*1573	2	Double door/manual close	M2060W	FM	NFPA, OSHA
				Double door/self close	S2060W		
90	1090*860*1720	1007*777*1573	2	Double door/manual close	M2090W	FM	NFPA, OSHA
				Double door/self close	S2090W		

※Sliding door cabinets are available, if needed, please contact your local sales representative for detail.
 ※Extra steel shelves can be ordered.

Undercounter Safety Cabinets

Can be installed under work desks, laboratory tables and chemical fume hoods. Provides space-saving characteristics and offers convenient access to goods.



22 gallon



7 gallon



10 gallon



11 gallon

- FM Approvals certified, comply with NFPA & OSHA regulations.
- Heavy-duty steel construction.
- Lead-free epoxy powder coating finish.
- Double wall construction with 38mm air space efficiently isolates from combustion.
- Galvanized steel shelves.
- 3-point self-latching doors with all non-spark latching.
- Paddle handle locking latch.
- 1.2mm cold-rolled continuous piano hinge.
- Adjustable zinc plated leveling feet.
- Dual 2" vents with caps and flame arrester placed at both side of cabinets.
- Large warning label.
- Static grounding wire (UL listed).
- 2 inch deep leak-tight containment sump.
- Option: red and blue colors.



Capacity gallon	Ext. Dim. W*D*H mm	Int. Dim. W*D*H mm	No. of Shelves	Door Type	Order No.	Approval	Compliance
7	555*520*740	472*437*593	1	Single door/manual close	M1007Y-1	FM	NFPA, OSHA
				Single door/self close	S1007Y-1		
7	555*520*570	472*437*423	1	Single door/manual close	M1007Y-2	FM	NFPA, OSHA
				Single door/self close	S1007Y-2		
10	705*520*740	622*437*593	1	Single door/manual close	M1010Y-1	FM	NFPA, OSHA
				Single door/self close	S1010Y-1		
10	705*520*570	622*437*423	1	Single door/manual close	M1010Y-2	FM	NFPA, OSHA
				Single door/self close	S1010Y-2		
11	855*520*740	772*437*593	1	Double door/manual close	M2011Y-1	FM	NFPA, OSHA
				Double door/self close	S2011Y-1		
11	855*520*570	772*437*423	1	Double door/manual close	M2011Y-2	FM	NFPA, OSHA
				Double door/self close	S2011Y-2		
22	1415*520*740	1332*437*593	1	Double door/manual close	M2022Y-1	FM	NFPA, OSHA
				Double door/self close	S2022Y-1		
22	1415*520*570	1332*437*423	1	Double door/manual close	M2022Y-2	FM	NFPA, OSHA
				Double door/self close	S2022Y-2		
22	1115*520*740	1032*437*593	1	Double door/manual close	M2022Y-3	FM	NFPA, OSHA
				Double door/self close	S2022Y-3		
22	1115*520*570	1032*437*423	1	Double/manual close	M2022Y-4	FM	NFPA, OSHA
				Double/self close	S2022Y-4		

Gas Cylinder Cabinets

Built-in casting aluminum alloy U-shaped holder and adjustable nylon straps. Ideal to fix all kinds of gas cylinders. Slip steel ramp plate facilitates the cylinders up and down.

- FM Approvals certified, comply with NFPA & OSHA regulations.
- Heavy-duty steel construction.
- Lead-free epoxy powder coating finish.
- Double wall construction with 38mm air space efficiently isolates from combustion.
- 3-point self-latching doors with all non-spark latching.
- Paddle handle locking latch.
- 1.2mm cold-rolled continuous piano hinge.
- Adjustable zinc plated leveling feet.
- Dual 2" vents with caps and flame arrester placed at both side of cabinets.
- Large warning label.
- Static grounding wire (UL listed).
- 2 inch deep leak-tight containment sump.
- Option: red and blue colors.



Aluminum alloy U-shaped holder with adjustable nylon straps. Ideal to fix all kinds of gas cylinders.

Capacity gallon	Ext. Dim. W*D*H mm	Int. Dim. W*D*H mm	No. of Shelves	Door Type	Order No.	Approval	Compliance
45	1090*460*1720	1007*377*1573	-	Double door/manual close	M2045Y-G	FM	NFPA, OSHA
				Double door/self close	S2045Y-G		

Drum Cabinets

Specific to the storage of Horizontal drum and Vertical drum.

- FM Approvals certified, comply with NFPA & OSHA regulations.
- Heavy-duty steel construction.
- Lead-free epoxy powder coating finish.
- Double wall construction with 38mm air space efficiently isolates from combustion.
- 3-point self-latching doors with all non-spark latching.
- Paddle handle locking latch.
- 1.2mm cold-rolled continuous piano hinge.
- Adjustable zinc plated leveling feet.
- Dual 2" vents with caps and flame arrester placed at both side of cabinets.
- Large warning label.
- Static grounding wire (UL listed).
- 2 inch deep leak-tight containment sump.
- Option: red and blue colors.



Horizontal



Vertical

Capacity gallon	Ext. Dim. W*D*H mm	Int. Dim. W*D*H mm	No. of Shelves	Door Type	Order No.	Approval	Compliance
55	760*1220*1220	677*1137*1073	-	Double door/manual close	M2055Y-H	FM	NFPA, OSHA
				Double door/self close	S2055Y-H		
55	860*860*1720	777*777*1573	1	Double door/manual close	M2055Y-V	FM	NFPA, OSHA
				Double door/self close	S2055Y-V		

Vent-Filtration Box

YAKOS65™ Vent-Filtration® Box allows you to filter out chemical vapors inside of a safety cabinet and returns clean air back to the workplace via a unique standalone system.

Built-in an excellent energy efficiency brushless DC blower and widely used filters for most of solvents and chemical. It serves as an air purification system for most of chemical safety cabinet on the market.

Effectively reduce the concentration of chemical solvent vapors inside the cabinet and provide the best protection for laboratory personnel.



APPLICATIONS

Flexible cabinet ventilation for storage of:

- Flammable chemicals
- Paints, ink
- Corrosive chemicals
- Pesticides
- Toxic materials

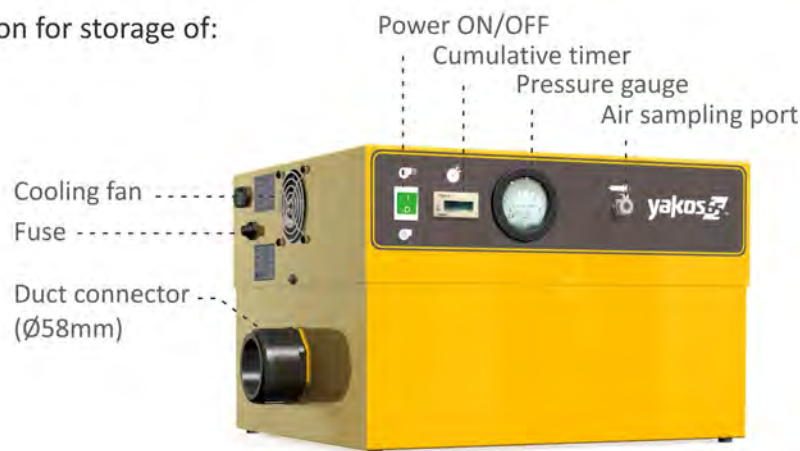

MAIN FEATURES

- Capture toxic vapors, odors and smells generated by chemicals stored in a safety or chemical cabinet.
- Protection of chemical inhalation risks.
- Simple and fast installation.
- No exhaust ductwork needed.
- Fits to most of available flammables safety cabinets on the market.
- Ultra-low energy consumption of 20 watts.

Model:ECD-027-AA-A

1. Construction : SECC galvanized steel with epoxy powder coating
2. Overall dimensions : 440*380*290mm
3. Filter : Active coal filter for most of solvent, organic vapor removal
4. Airflow : 60 m³/h (3.54 CFM)
5. Noise : <55 dBA
6. Hose : Stainless steel, 60cm, flexible
7. Power consumption : 20 watt
8. Power voltage/Hz : 88 ~ 264 VAC / 47 ~ 63 Hz
9. Air sampling port : Sampling access to allow the filter saturation to be tested
10. Shipping weight : 20 kg
11. Shipping dimensions : 700*460*300 mm
12. Accessories :
 - Pressure gauge(0 ~ 25 mmAq) X 1

- Operation manual X 1
- Flexible duct length:60cm(Ø58mm) X 1
- Duct connector(Ø58mm) X 2
- AC power cord(1.2meter) x 1
- Active coal filter X 2



Aerosol Storage Cages

Aerosol cans are widely used for delivering personal-care products, paints, lubricants, insectrepellent, gardening and automotive goods to consumers. Aerosol cans are pressurized containers and classified as Dangerous Goods under Class 2, with a listed international reference number of UN1950.

All aerosol cans present a significant hazard in workplaces and in society because of the compressed gas used as a propellant. When exposed to fire, aerosol cans will either violently rupture or produce burning jets of flame. It is very important to store aerosol cans safely.

YAKOS65™ Aerosol Storage Cages range from 100 up to 420 aerosol cans (66mm diameter, 245mm height) depending on cage model. They are constructed from heavy duty, powder-coated steel, robust and easy to operate.

YAKOS65™ aerosol storage cages feature high open area perforations which deliver natural ventilation, and all appropriate warning and safety signs is included. Bolt down plates allow the cage to be permanently fixed for added security and all doors can be locked using the padlock lug (padlocks are not supplied). Safely store up to 420 aerosol spray cans in this heavy duty, powder-coated steel aerosol storage cage.

- Heavy-duty, green powder-coated steel construction.
- Suitable for storage of up to 420 aerosol cans (66mm diameter, 245mm height)
- Solid steel roof and floor with mesh wall panels to provide wide open area perforations deliver natural ventilation.
- Robust, lightweight and easy to operate.
- Door can be locked using the padlock lug (padlock not supplied).
- Bolt down plates enable the cage to be permanently fixed to the ground for added security.
- Includes appropriate warning and safety signs.
- All aerosol can cages are supplied with a Class 2 Flammable Gas warning sign.



Model No.	Ext. Dimensions(mm)	Door #	Shelf #	Capacity
CNA-064-AA-A	W700xD400xH600	1	1	100 cans
CNA-128-AA-A	W700xD400xH1160	1	3	200 cans
CNA-256-AA-A	W700xD750xH1160	1	3	400 cans
CNB-192-AA-A	W1100xD400xH1720	2	10	420 cans

Emergency Information Cabinet



A Safety Data Sheet (SDS), Material Safety Data Sheet (MSDS), or Product Safety Data Sheet (PSDS) is an important component of product stewardship, occupational safety and health, and spill-handling procedures. MSDS formats can vary from source to source within a country depending on national requirements.

MSDS is a widely used system for cataloging information on chemicals, chemical compounds, and chemical mixtures. MSDS information may include instructions for the safe use and potential hazards associated with a particular material or product.

The MSDS should be available for reference in the area where the chemicals are being stored or in use. An Emergency Information Cabinet keeps these important documents secure and readily available to users whilst protecting them from moisture and dirt.

FEATURES

- Store important documents or emergency information, such as MSDS.
- Large or small, two sizes available. Enough for MSDS binder.
- Manufactured from high-visibility red powder-coated steel construction.
- Large "EMERGENCY INFORMATION" label in white lettering.
- Lockable, rain-proof (weatherproof).



CLA-035-AA-A

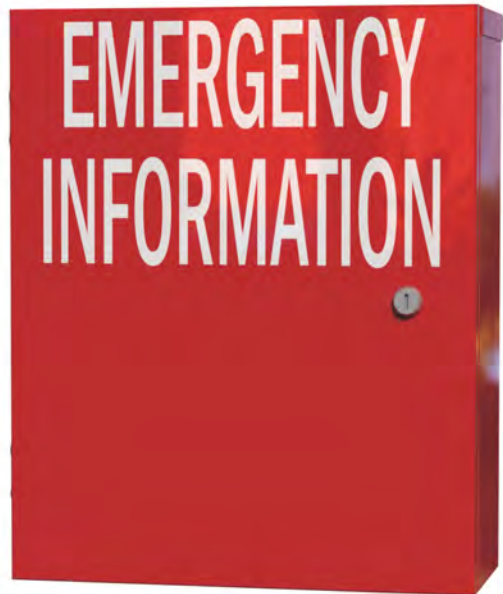

CLA-050-AA-A

Model No.	Width	Depth	Height
CLA-035-AA-A	350 mm	150 mm	425 mm
CLA-050-AA-A	500 mm	156 mm	600 mm

SALES REFERENCE



For more detailed information, please visit YAKOS65 website at www.yakos65.com and contact with our local distributors.

YAKOS65's responsibility is to provide customers with comprehensive solutions. Please let us know what you are looking for so that we can process your inquiry as quickly and efficiently as possible.



CHUNG FU TECHNICAL DEVELOPMENT CO., LTD

No.33-1, NanShih, LinKou Dist., New Taipei City 244, Taiwan

TEL: +886 2 2600 1761 & FAX: +886 2 2600 6801

EMAIL: sales@yakos65.com

www.yakos65.com

www.chungfu.com.tw

Biological Safety Cabinet | Flammables Safety Storage Cabinet | Zebrafish Housing System | Chemical Fume Hood